

# PRELIMINARY

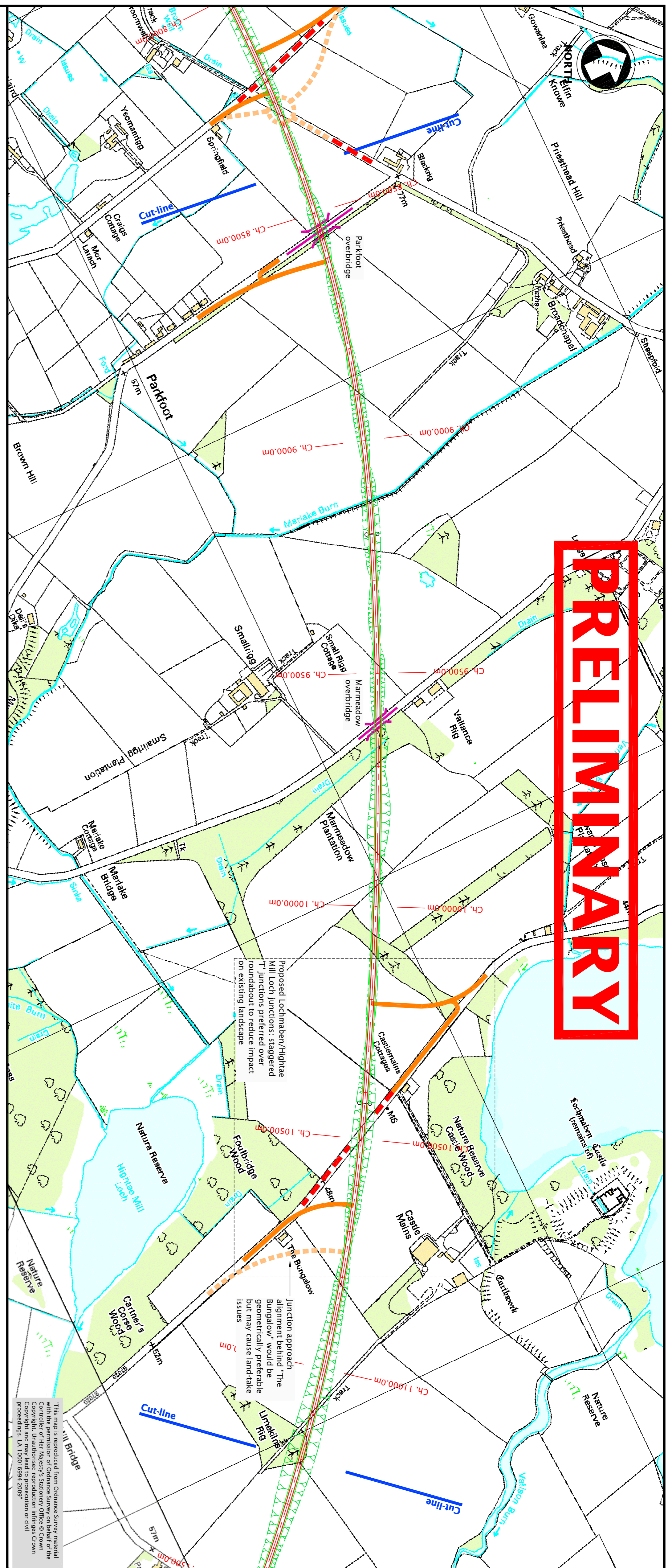

Proposed Loddham/Highgate Mill Junctions: staggered 'T' junctions preferred over roundabouts to reduce impact on existing landscape.

Junction approach behind 'The Bungalow' would be better served by a bridge structure to avoid the burnway cause land take issues.

This map is reproduced from Ordnance Survey material. The copyright in this material remains the property of Her Majesty's Stationery Office. Crown Copyright. Unauthorised reproduction infringes Crown Copyright and may lead to prosecution or civil proceedings. OS 100019737

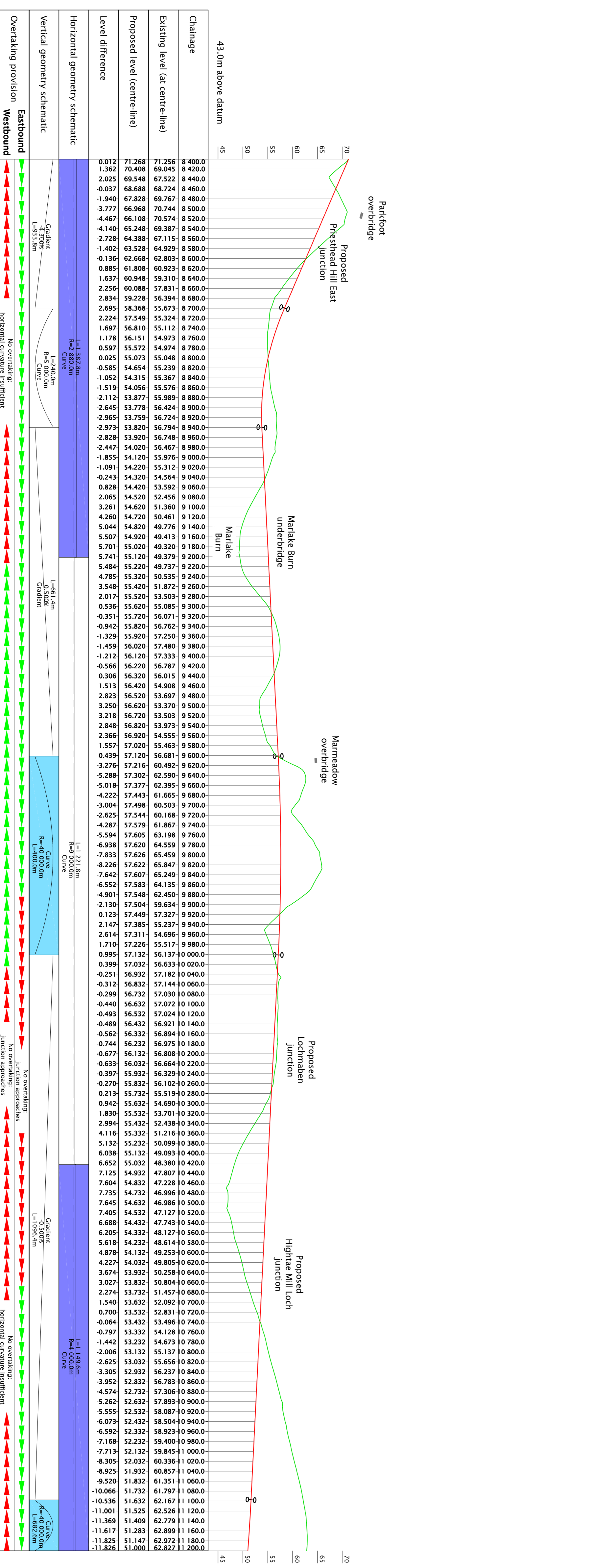

**Notes**

- Horizontal alignment based on Ordnance Survey Mastermap data supplied by Dumfries and Galloway Council - licence as shown on plan.
- Vertical alignment and earthworks footprint based on NextMap Digital Terrain Model supplied by Dumfries and Galloway Council.

**Key to Route Plan**

- Proposed Main Line A709 alignment, carriageway and earthworks footprint
- Proposed junction location, or existing junction to be retained
- Alternative junction layout/location
- Proposed overbridge/junderbridge to maintain existing highway or provide accommodation crossing
- Existing highway to be stopped off

**Key to Longitudinal Section and Schematics**

- Proposed vertical alignment profile with tangent points and ordinates at 20m intervals
- Existing ground level profile along proposed centre-line
- Compliance of alignment geometry elements with DMRB standards (listed in order of ascending severity)
- Minimum to provide overtaking in both directions\*\*
- Sufficient to provide overtaking in one direction only\*\*
- Above Desirable Minimum but not sufficient to provide overtaking
- Desirable Minimum (or Desirable Maximum gradient)
- 1 Step below Desirable Minimum\*\*

**Overtaking provision schematic**

- Extent of Overtaking Section
- Extent of Non-overtaking Section with reason(s) for restriction
- NB Overtaking schematic is generally divided into Eastbound and Westbound directions as indicated by the arrowheads

**Client:**  
**myvaconsultancy**  
 7th Floor  
 78 St Vincent Street  
 Glasgow  
 G2 5UB

**Mott MacDonald**  
 111 St. Mary's Road  
 Sheffield S2 4AP  
 United Kingdom  
 T +44 (0)114 2781242  
 F +44 (0)114 2726899  
 M www.mottmac.com

**Alignment Route Plan and Longitudinal Section**  
 Chainage 8400m to 11200m (Sheet 4 of 6)

Designed: C Broughton  
 Drawn: C Broughton  
 Dwg.Chtk: CSheehan@mm.com

Eng.Chtk: S Rothenham  
 Coordination: Approved  
 M A Saniland

Scale at AI: 1:5000 Hor./1:5000 Ver.  
 Drawing No: 254583 / SHF / 1104

**Rev** | **Date** | **Drawn** | **Description** | **CHK'D** | **App'd**

P1	02/03/2009		Preliminary Issue		
----	------------	--	-------------------	--	--

**The:**  
 Dumfries to A74(M) Link STAG2  
 A709 Single Carriageway Off-line Option

**Status:**  
 PRE

© Mott MacDonald Limited 2009  
 This document should not be relied on or used in circumstances other than those for which it was originally prepared and for which Mott MacDonald Ltd was commissioned. Mott MacDonald Ltd accepts no responsibility for any other party other than the person by whom it was commissioned.

Project: 254583  
 CAD file: 254583.dwg  
 1:5000 Hor./1:5000 Ver.  
 Drawing No: 254583 / SHF / 1104