

Notes

- Horizontal alignment based on Ordnance Survey MasterMap data supplied by Dumfries and Galloway Council - licence as shown on plan.
- Vertical alignment and earthworks footprint based on NextMap Digital Terrain Model supplied by Dumfries and Galloway Council.

Key to Route Plan

- Proposed Main Line A75 alignment carriageway and earthworks footprint
- Proposed junction location, or existing junction to be retained
- Alternative junction/side road layout for consideration
- Proposed overbridge/underbridge to maintain existing highway or provide accommodation crossing
- Existing highway to be stopped off

Key to Longitudinal Section and Schematics

Section profiles

- Proposed vertical alignment profile with tangent points and ordinates at 100m intervals
- Existing ground level profile along proposed alignment centre-line
- Existing ground level profile along proposed Eastbound/North side carriageway centre-line
- Existing ground level profile along proposed Westbound/South side carriageway centre-line

Compliance of alignment geometry elements with DMRB standards (listed in ascending order of severity)

- Desirable Minimum (or Desirable Maximum gradient)
- 1 Step below Desirable Minimum
- 2 Steps below Desirable Minimum

This map is reproduced from Ordnance Survey material with the permission of Ordnance Survey on behalf of the Controller of Her Majesty's Stationery Office © Crown Copyright. Unauthorised reproduction infringes Crown Copyright and may lead to prosecution or civil proceedings. LA 11001 6994 2009

Design Manual for Roads and Bridges, Volume 6, Section 1, Part 1, TD 9/93 Highway Link Design

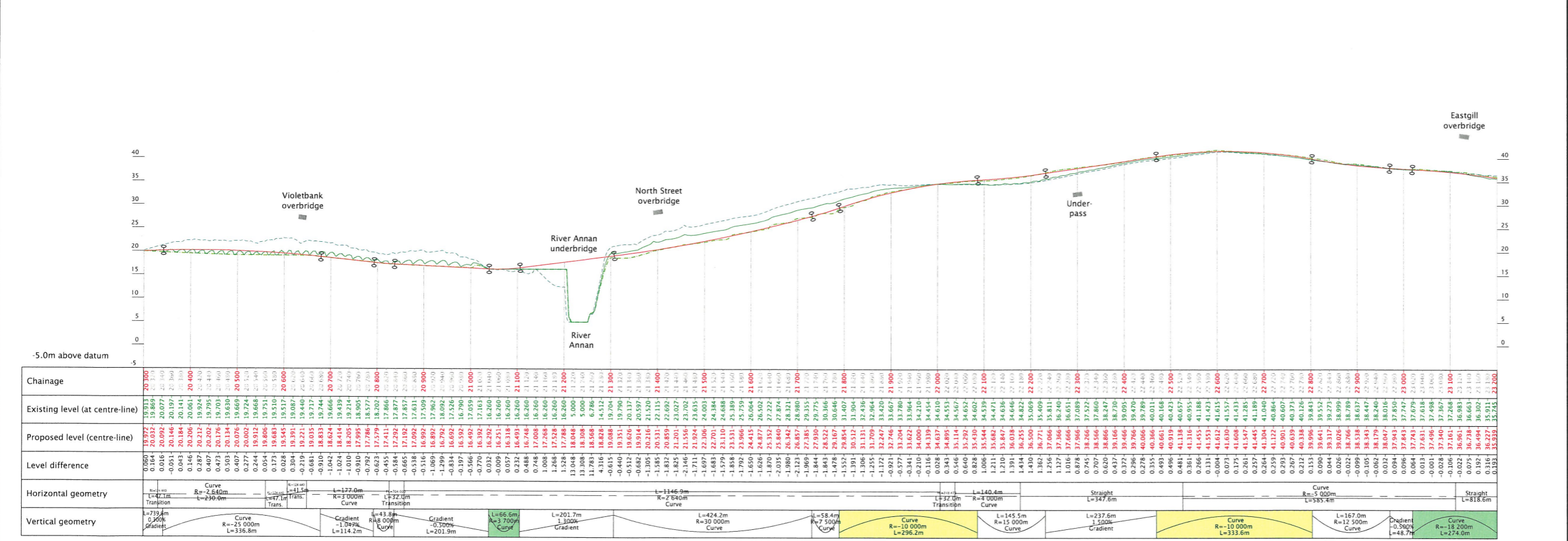

Chainage	Existing level (at centre-line)	Proposed level (centre-line)	Level difference	Horizontal geometry	Vertical geometry
20 300	19.912	19.912	0.000	Curve R=230.0m	Curve R=230.0m
20 400	20.000	20.000	0.000	Curve R=230.0m	Curve R=230.0m
20 500	20.100	20.100	0.000	Curve R=230.0m	Curve R=230.0m
20 600	20.200	20.200	0.000	Curve R=230.0m	Curve R=230.0m
20 700	20.300	20.300	0.000	Curve R=230.0m	Curve R=230.0m
20 800	20.400	20.400	0.000	Curve R=230.0m	Curve R=230.0m
20 900	20.500	20.500	0.000	Curve R=230.0m	Curve R=230.0m
21 000	20.600	20.600	0.000	Curve R=230.0m	Curve R=230.0m
21 100	20.700	20.700	0.000	Curve R=230.0m	Curve R=230.0m
21 200	20.800	20.800	0.000	Curve R=230.0m	Curve R=230.0m
21 300	20.900	20.900	0.000	Curve R=230.0m	Curve R=230.0m
21 400	21.000	21.000	0.000	Curve R=230.0m	Curve R=230.0m
21 500	21.100	21.100	0.000	Curve R=230.0m	Curve R=230.0m
21 600	21.200	21.200	0.000	Curve R=230.0m	Curve R=230.0m
21 700	21.300	21.300	0.000	Curve R=230.0m	Curve R=230.0m
21 800	21.400	21.400	0.000	Curve R=230.0m	Curve R=230.0m
21 900	21.500	21.500	0.000	Curve R=230.0m	Curve R=230.0m
22 000	21.600	21.600	0.000	Curve R=230.0m	Curve R=230.0m
22 100	21.700	21.700	0.000	Curve R=230.0m	Curve R=230.0m
22 200	21.800	21.800	0.000	Curve R=230.0m	Curve R=230.0m
22 300	21.900	21.900	0.000	Curve R=230.0m	Curve R=230.0m
22 400	22.000	22.000	0.000	Curve R=230.0m	Curve R=230.0m
22 500	22.100	22.100	0.000	Curve R=230.0m	Curve R=230.0m
22 600	22.200	22.200	0.000	Curve R=230.0m	Curve R=230.0m
22 700	22.300	22.300	0.000	Curve R=230.0m	Curve R=230.0m
22 800	22.400	22.400	0.000	Curve R=230.0m	Curve R=230.0m
22 900	22.500	22.500	0.000	Curve R=230.0m	Curve R=230.0m
23 000	22.600	22.600	0.000	Curve R=230.0m	Curve R=230.0m
23 100	22.700	22.700	0.000	Curve R=230.0m	Curve R=230.0m
23 200	22.800	22.800	0.000	Curve R=230.0m	Curve R=230.0m
23 300	22.900	22.900	0.000	Curve R=230.0m	Curve R=230.0m
23 400	23.000	23.000	0.000	Curve R=230.0m	Curve R=230.0m
23 500	23.100	23.100	0.000	Curve R=230.0m	Curve R=230.0m
23 600	23.200	23.200	0.000	Curve R=230.0m	Curve R=230.0m
23 700	23.300	23.300	0.000	Curve R=230.0m	Curve R=230.0m
23 800	23.400	23.400	0.000	Curve R=230.0m	Curve R=230.0m
23 900	23.500	23.500	0.000	Curve R=230.0m	Curve R=230.0m
24 000	23.600	23.600	0.000	Curve R=230.0m	Curve R=230.0m
24 100	23.700	23.700	0.000	Curve R=230.0m	Curve R=230.0m
24 200	23.800	23.800	0.000	Curve R=230.0m	Curve R=230.0m
24 300	23.900	23.900	0.000	Curve R=230.0m	Curve R=230.0m
24 400	24.000	24.000	0.000	Curve R=230.0m	Curve R=230.0m
24 500	24.100	24.100	0.000	Curve R=230.0m	Curve R=230.0m
24 600	24.200	24.200	0.000	Curve R=230.0m	Curve R=230.0m
24 700	24.300	24.300	0.000	Curve R=230.0m	Curve R=230.0m
24 800	24.400	24.400	0.000	Curve R=230.0m	Curve R=230.0m
24 900	24.500	24.500	0.000	Curve R=230.0m	Curve R=230.0m
25 000	24.600	24.600	0.000	Curve R=230.0m	Curve R=230.0m
25 100	24.700	24.700	0.000	Curve R=230.0m	Curve R=230.0m
25 200	24.800	24.800	0.000	Curve R=230.0m	Curve R=230.0m
25 300	24.900	24.900	0.000	Curve R=230.0m	Curve R=230.0m
25 400	25.000	25.000	0.000	Curve R=230.0m	Curve R=230.0m
25 500	25.100	25.100	0.000	Curve R=230.0m	Curve R=230.0m
25 600	25.200	25.200	0.000	Curve R=230.0m	Curve R=230.0m
25 700	25.300	25.300	0.000	Curve R=230.0m	Curve R=230.0m
25 800	25.400	25.400	0.000	Curve R=230.0m	Curve R=230.0m
25 900	25.500	25.500	0.000	Curve R=230.0m	Curve R=230.0m
26 000	25.600	25.600	0.000	Curve R=230.0m	Curve R=230.0m
26 100	25.700	25.700	0.000	Curve R=230.0m	Curve R=230.0m
26 200	25.800	25.800	0.000	Curve R=230.0m	Curve R=230.0m
26 300	25.900	25.900	0.000	Curve R=230.0m	Curve R=230.0m
26 400	26.000	26.000	0.000	Curve R=230.0m	Curve R=230.0m
26 500	26.100	26.100	0.000	Curve R=230.0m	Curve R=230.0m
26 600	26.200	26.200	0.000	Curve R=230.0m	Curve R=230.0m
26 700	26.300	26.300	0.000	Curve R=230.0m	Curve R=230.0m
26 800	26.400	26.400	0.000	Curve R=230.0m	Curve R=230.0m
26 900	26.500	26.500	0.000	Curve R=230.0m	Curve R=230.0m
27 000	26.600	26.600	0.000	Curve R=230.0m	Curve R=230.0m
27 100	26.700	26.700	0.000	Curve R=230.0m	Curve R=230.0m
27 200	26.800	26.800	0.000	Curve R=230.0m	Curve R=230.0m
27 300	26.900	26.900	0.000	Curve R=230.0m	Curve R=230.0m
27 400	27.000	27.000	0.000	Curve R=230.0m	Curve R=230.0m
27 500	27.100	27.100	0.000	Curve R=230.0m	Curve R=230.0m
27 600	27.200	27.200	0.000	Curve R=230.0m	Curve R=230.0m
27 700	27.300	27.300	0.000	Curve R=230.0m	Curve R=230.0m
27 800	27.400	27.400	0.000	Curve R=230.0m	Curve R=230.0m
27 900	27.500	27.500	0.000	Curve R=230.0m	Curve R=230.0m
28 000	27.600	27.600	0.000	Curve R=230.0m	Curve R=230.0m
28 100	27.700	27.700	0.000	Curve R=230.0m	Curve R=230.0m
28 200	27.800	27.800	0.000	Curve R=230.0m	Curve R=230.0m
28 300	27.900	27.900	0.000	Curve R=230.0m	Curve R=230.0m
28 400	28.000	28.000	0.000	Curve R=230.0m	Curve R=230.0m
28 500	28.100	28.100	0.000	Curve R=230.0m	Curve R=230.0m
28 600	28.200	28.200	0.000	Curve R=230.0m	Curve R=230.0m
28 700	28.300	28.300	0.000	Curve R=230.0m	Curve R=230.0m
28 800	28.400	28.400	0.000	Curve R=230.0m	Curve R=230.0m
28 900	28.500	28.500	0.000	Curve R=230.0m	Curve R=230.0m
29 000	28.600	28.600	0.000	Curve R=230.0m	Curve R=230.0m
29 100	28.700	28.700	0.000	Curve R=230.0m	Curve R=230.0m
29 200	28.800	28.800	0.000	Curve R=230.0m	Curve R=230.0m
29 300	28.900	28.900	0.000	Curve R=230.0m	Curve R=230.0m
29 400	29.000	29.000	0.000	Curve R=230.0m	Curve R=230.0m
29 500	29.100	29.100	0.000	Curve R=230.0m	Curve R=230.0m
29 600	29.200	29.200	0.000	Curve R=230.0m	Curve R=230.0m
29 700	29.300	29.300	0.000	Curve R=230.0m	Curve R=230.0m
29 800	29.400	29.400	0.000	Curve R=230.0m	Curve R=230.0m
29 900	29.500	29.500	0.000	Curve R=230.0m	Curve R=230.0m
30 000	29.600	29.600	0.000	Curve R=230.0m	Curve R=230.0m

PI	26/03/09	Preliminary Issue		
Rev	Date	Drawn	Description	Ch'k'd
				App'd

Mott MacDonald

Mott MacDonald House
111 St. Mary's Road
Sheffield S2 4AP
United Kingdom
T +44 (0)114 2761242
F +44 (0)114 2724699
W www.mottmac.com

Client
mvaconsultancy

7th Floor
78 St Vincent Street
Glasgow
G2 5UB

Title
Dumfries to A74(M) Link STAG2
A75 On-line Dualling Option

**Alignment Route Plan and Longitudinal Section
Chainage 20300m to 23200m (Sheet 8 of 12)**

Designed	C Broughton	Eng.Chk.	S Rotherham
Drawn	C Broughton	Coordination	
Dwg.Chk.	C Sri-Pathanathan	Approved	M A Staniland
Scale at A1	Project	254583	Status
1:5000 Hor./1:500 Ver.	CAD file	F:\Sheffield\214181 Dumfries STAG2 Highway A75 On-line Dualling Option - Current\Kasari\2008.dwg STAG2_A75_On-Line_P1.dwg	PRE
Drawing No	254583 / SHF / 1508	Rev	P1

© Mott MacDonald Limited 2009
This document should not be relied on or used in circumstances other than those for which it was originally prepared and for which Mott MacDonald Ltd was commissioned. Mott MacDonald Ltd accepts no responsibility for this document to any other party other than the person by whom it was commissioned.